

QUICK-FLANGE INSTALLATION INSTRUCTION SHEET

Each MiniMax Plus Quick-Flange Accessory Kit contains the following items:

One (1) Quick-Flange unit
Four (4) 3/8 Bolts

Two (2) 2 in. Rubber gaskets
Four (4) 3/8 in. Washers

Two (2) Plastic Sleeves

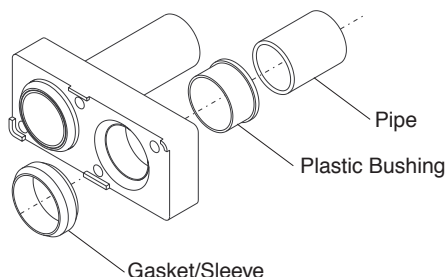

FOR 1½ & 2 in. SCHEDULE 40 PVC PIPE

1. Insert plastic sleeves into the “Quick-Flange” inlet/outlet openings.
2. Slip the 2 in. rubber gaskets over the plastic sleeves.
3. Bolt the “Quick-Flange” to the header.

NOTE

Tighten the bolts evenly! Do not over tighten!

4. Use plumbers roll or medium grit sand paper and clean the inlet/outlet openings of the “Quick-Flange”. Use the same method to clean the 2 in. PVC pipe. The sand paper will break up any grease or contaminant that may not be cleaned away with a primer.
5. Use 711 PVC glue (or equivalent) and follow the manufacturer’s recommendations. Apply to the inlet opening of the “Quick-Flange”. Do the same to the PVC pipe and quickly insert the pipe into the “Quick-Flange” and twist the pipe a 1/4 turn. Do the same to the other opening of the “Quick-Flange”.
6. For 1½ in. PVC pipe installations, first glue a 1½ in. X 2 in. sch 40 PVC bushing (not supplied or shown) to the end of the pipe prior to gluing to the “Quick-Flange”.

FOR 1½ & 2 in. COPPER PIPE

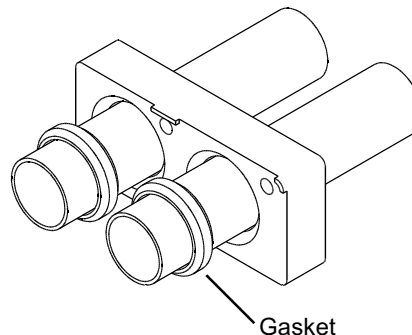

NOTE

You **“DO NOT”** need the plastic bushings.*

1. Insert pipe into the inlet/outlet openings of the “Quick-Flange”
2. Slip the rubber gaskets over the pipe, using the supplied 2 in. rubber gasket for 2 in. copper pipe or the 1½ in. rubber gasket (not supplied, available from the factory) for the 1½ in. copper pipe.
3. Bolt the “Quick-Flange” to the header.

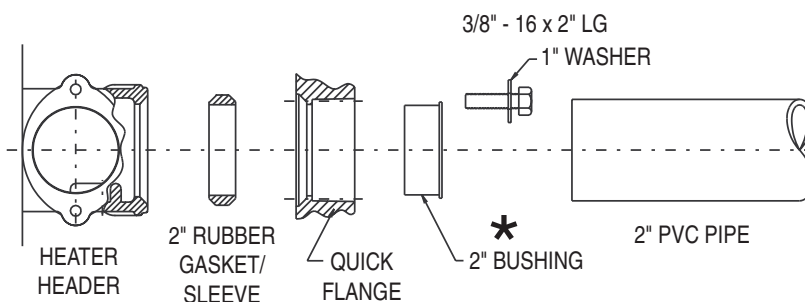

Pentair Water Pool and Spa, Inc.

1620 Hawkins Ave., Sanford, NC 27330 • (919) 566-8000

10951 W. Los Angeles Ave., Moorpark, CA 93021 • (805) 523-2400

P/N 075282 • Rev. B 7/05